



Easy solution for **WAIT / ENTER** signalisation

Your Challenge

- Manage number of people in a closed area
- Quickly adapt existing infrastructure

Our Solution

- XB5R Wireless battery-less push-button
- XVU Tower light

Your Benefits

- Simple “wait” / “enter” indication for consumers
- Simple control by employees
- Simple installation
- Peace of mind as no battery needed
- Touch of design thanks to the XVU tower light

CONTROL



Life Is On

Schneider
Electric

Easy solution for WAIT / ENTER regulation

Harmony Tower Lights products – promotion videos

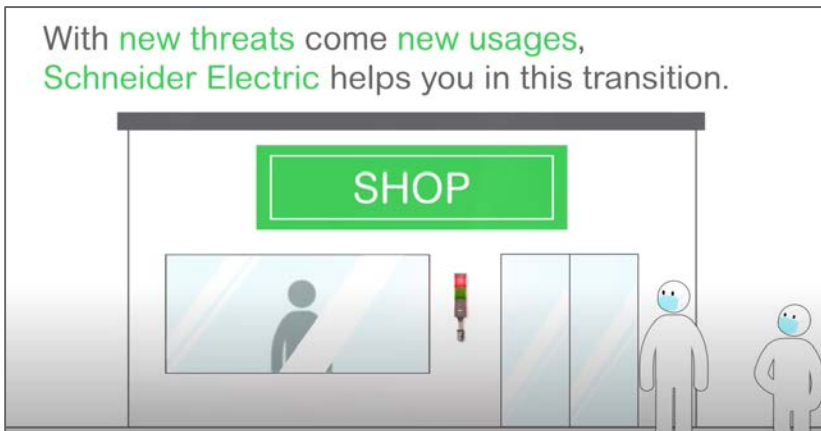

Harmony Solutions for Social Distancing



Harmony Signaling for Operational Efficiency



2 buttons / 2 colors



Wireless control box
ZBRM22A0



Wireless relay
ZBRR
24/230V AC/DC

[catalog](#)



EZ9E108S2S

Bill Of Material



XVUC24



XVUC23



XVUC21M
230V AC/DC



XVUZ100T

[catalog](#) *

* *Alternative
Easy Harmony*

Installation (230V AC/DC)



PB1
PB2



Configuration:
Start/stop

Output pairing (Q1):
Start: **PB1**
Stop: **PB2**

[How To Videos](#)

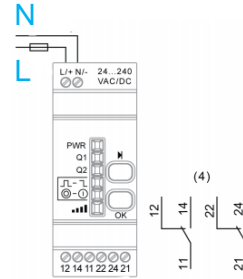

11 ← COM
14 → L1
12 → L2

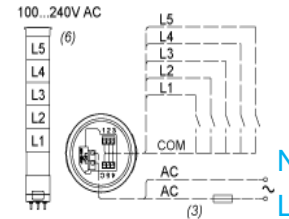

[datasheet](#)

Life Is On

Schneider
Electric

